

DROP (N) TELL[®]

Instructions for Use

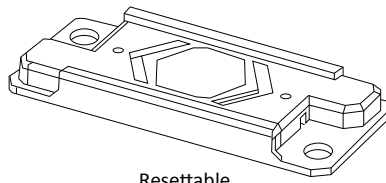

Resettable

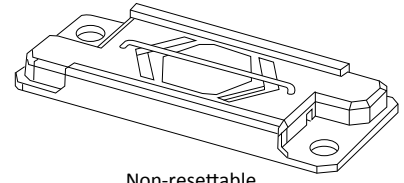

Non-resettable

Bill of lading labels and warning labels are located beneath the black tray.

Drop (N) Tell[®] Impact Indicator

This carton contains equal numbers of Drop (N) Tell[®] impact indicators and warning labels (located beneath the black tray) which together comprise a system to monitor your shipped product.

Attach the larger warning label to either the top or side of the package to be shipped.

Use the bill of lading label to alert the carrier that your shipment contains an impact monitor.



Mounting the Drop (N) Tell[®]

The Drop (N) Tell[®] may be placed on the inside or outside of the package.

Align the arrows on the face of the indicator with the direction of impact to be monitored (normally up/down).

Three indicators are required to monitor all three-dimensions (six directions).

Attaching the Drop (N) Tell[®]

Attach the Drop (N) Tell[®] using either the pressure sensitive tape provided on the back of the indicator or two No. 6 screws.

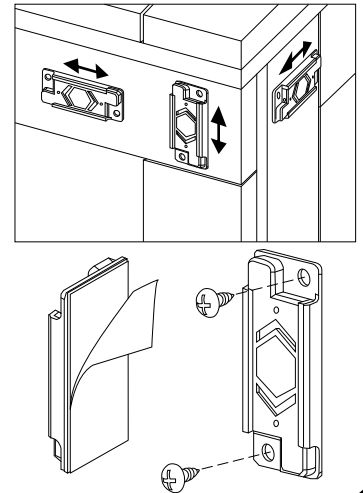

Activating the Drop (N) Tell[®]

To activate a non-resettable Drop (N) Tell[®] pull the metal lock pin from the front of the indicator. Take care not to trip the indicator when removing the pin as the device cannot be reset.

To activate a resettable Drop (N) Tell[®] push a small paper clip into the hole in the center of each end of the indicator. Apply only enough force to reset the indicator; you will hear or feel a slight "snap" as the arrow quickly moves to the activated (red) position.

Reading the Drop (N) Tell[®]

If your shipment experiences impact exceeding the selected Drop (N) Tell[®] trip point, the indicator window will appear dark blue.

